

REAR WHEEL HUB BOLT REPLACEMENT

1. REMOVE REAR WHEEL

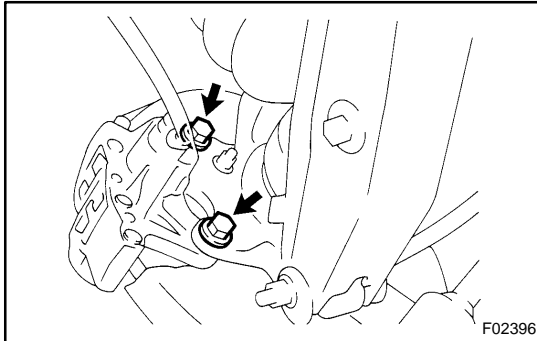

2. REMOVE BRAKE CALIPER AND DISC

- (a) Remove the 2 bolts and remove the brake caliper from the axle carrier.
- (b) Support the brake caliper securely.
- (c) Remove the disc.

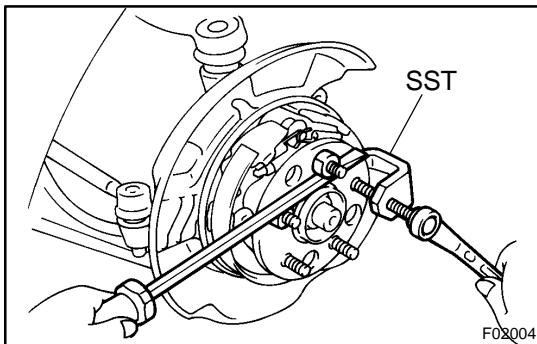

3. REMOVE HUB BOLT

Using SST, remove the hub bolt.

SST 09628-10011

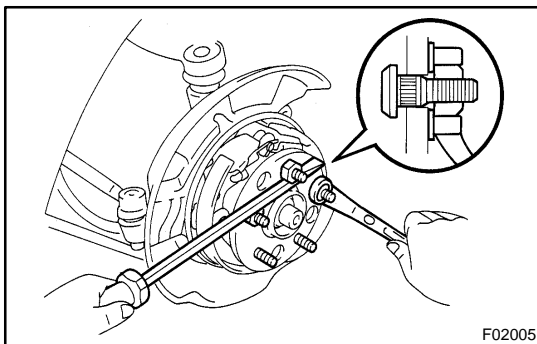

4. INSTALL HUB BOLT

- (a) Install a washer and nut to the bolt, as shown in the illustration.
- (b) Turn the wheel nut to pull the hub bolt until the underside of the hub bolt head touches the axle hub.

5. INSTALL DISC AND BRAKE CALIPER

- (a) Install the disc.
- (b) Install the brake caliper and 2 bolts to the axle carrier.

Torque: 104 N·m (1,065 kgf·cm, 77 ft·lbf)

6. INSTALL REAR WHEEL

Torque: 103 N·m (1,050 kgf·cm, 76 ft·lbf)